

Zelle® Payee Set Up Instructions – Personal Online Banking

1. Log into Columbia's Personal Online Banking or mobile app.
2. Select Transfers and payments (menu option).
3. Select Send money with Zelle®.
4. Click on the Plus icon (top Right).

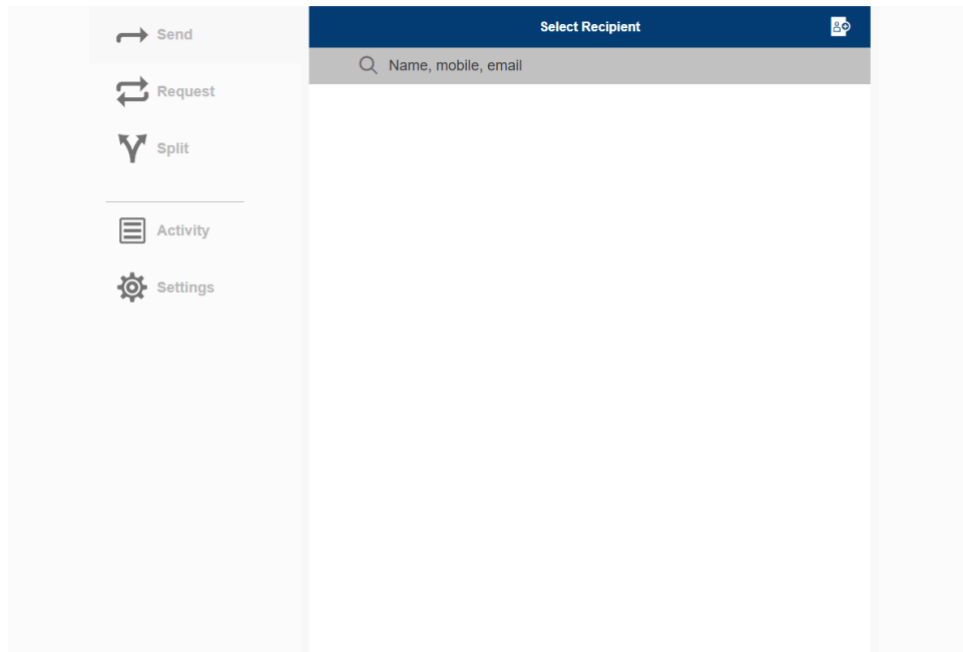

5. Enter Contact Name, Mobile Phone Number or email.

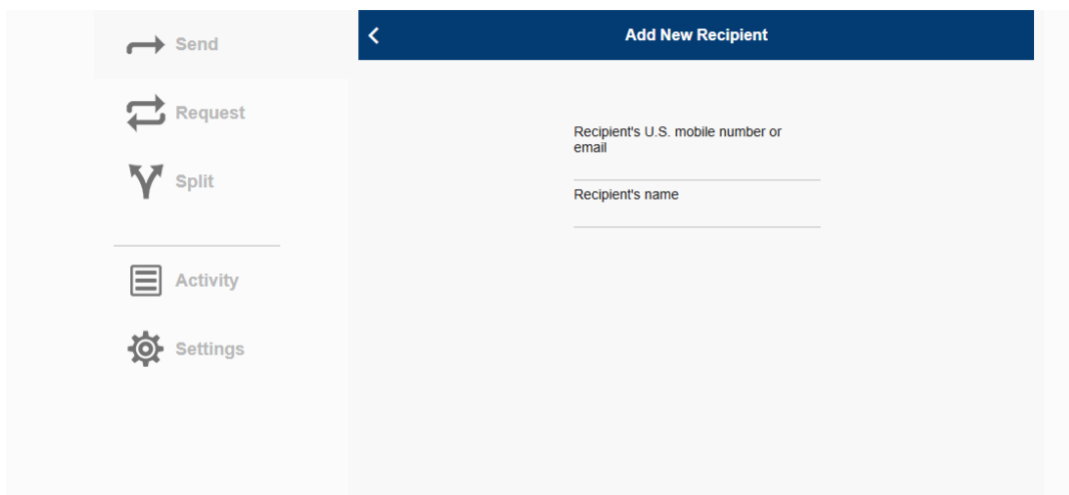

6. You will receive a pop-up to ensure users verify the payee information.

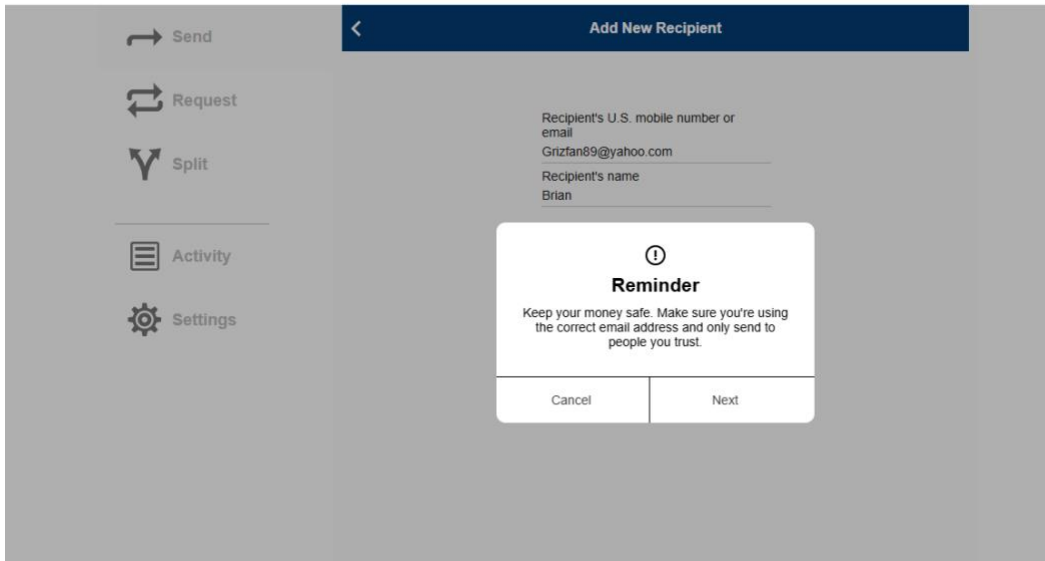

7. You may now continue to send your payment to new contact.